

Do Not Write Within Boxed Area,  
For Engineering Office Use Only.

**CITY OF NAPOLEON**

**ENGINEERING DEPARTMENT**

**SIGN PERMIT**

(Please Print or Type)

**COMPLETED**

|                |                 |
|----------------|-----------------|
| Permit No.     | 006606          |
| Issued         | 08-24-93        |
| By             | Brent N. Damman |
| Estimated Cost | \$3500.00       |
| Base Fee       | \$5.00          |
| Add            | \$7.24          |
| Total Fee      | \$12.24         |

Owner's Name ..... Emco Mkt.  
 Address ..... 500 Speedway Dr., Enon, OH 45323

Builder ..... National Illumination ..... 6923 Kipling Dr./P.O. Box 563 ..... Tel. .... 866-1666  
 & Sign Corp. ..... Holland, Ohio 43528

SIGN     BILLBOARD     AWNING     MARQUEE

Location of Project: ..... 501 North Perry

Additional Information: ..... Canopy face signs and post sign

Dimensions one (1) at 13.5 sf; one (1) at 35 sf ..... Square Feet ..... PAID 90.5  
 one (1) at 33 sf; one (1) at 9 sf ..... AUG 23 1993

Date ..... Signature of Applicant OF NAPOLEON

Application Must Be Accompanied with Sketch and Description of Proposed Installation  
 White - Applicant    Yellow - Clerk-Treasurer    Pink - Engineering    Gold - County Auditor

# **National\*** ILLUMINATION & SIGN CORPORATION

(419) 866-1666  
FAX (419) 866-5731

*The Lighting Maintenance Specialists*

August 19, 1993

City of Napoleon  
255 W. Riverview  
P.O. Box 151  
Napoleon, OH 43545  
Attn: Zoning Dept.  
Mr. Brent Damman

RE: United Station, 501 N. Perry Street

Dear Mr. Damman,

Per our meeting on August 18th, enclosed please find elevation drawing pertaining to location reidentification. You are holding signed permit form #00606 for this location. We have enclosed our check in the amount of \$12.24 to cover fees required. Changes should begin in about six (6) weeks.

Thanks for your help in this request.

Sincerely,

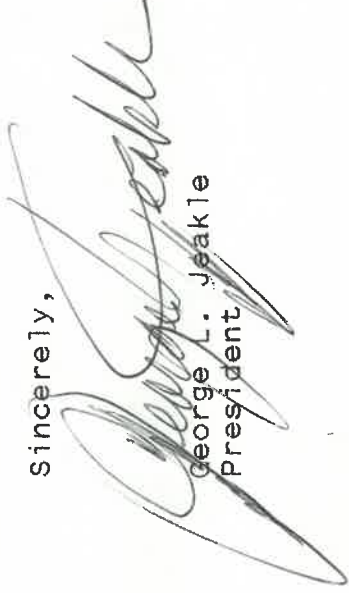
  
George L. Jeakle  
President

Enclosure

GLJ/ct

SPEEDWAY/UNITED STATION,  
501 N. PERRY ST.,  
NAPOLCON, OH.

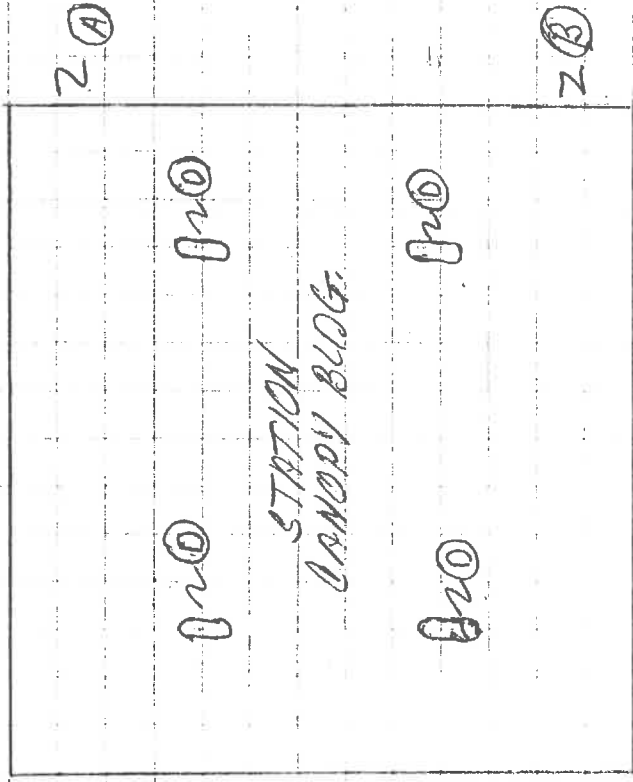

③ EXISTING 4'-6" X 8'-0" SIGN = 36 SQ.  
EXISTING 3'-0" X 6'-0" PRICER = 18 SQ. } = 54 SQ.

8'-0"  
↑ 2'-6"

P/L

501 N. PERRY STREET

# A 3- MOVING "S" LOGO PANELS (CANOPY FASCIA).

$$27\frac{1}{2}" \times 22" = 4.5 \text{ SQ. EA.} \times 3 = 13.5 \text{ SQ.} \times .08 \text{ \$/SQ.} = \$ 1.08$$

③ 2- "SPEEDWAY LETTER PANELS (CANOPY FASCIA).

$$114" \times 22" = 17.5 \text{ SQ. EA.} \times 2 = 35 \text{ SQ.} \times .08 \text{ \$/SQ.} = 2.80$$

③ 1- DOUBLE FACED LOGO/PRICER (POLE SIGN)

$$48" \times 99" = 33 \text{ SQ.} \times 1 = 33 \text{ SQ.} \times .08 \text{ \$/SQ.} = 2.64.$$

③ 4- FEDERAL INFORMATION SIGNS W/ LOGO (COLUMN)

$$18" \times 18" = 2.25 \text{ SQ. EA.} \times 4 = 9 \text{ SQ.} \times .08 \text{ \$/SQ.} = .72$$

ADMINISTRATIVE / RAILING FEE CHARGE: 5.00

TOTAL: 12.24

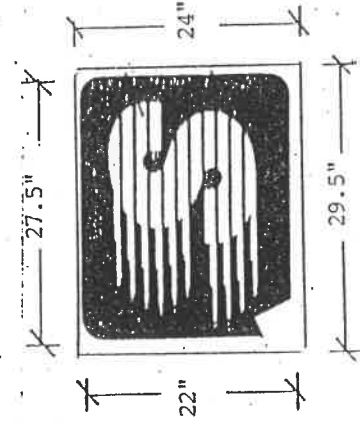
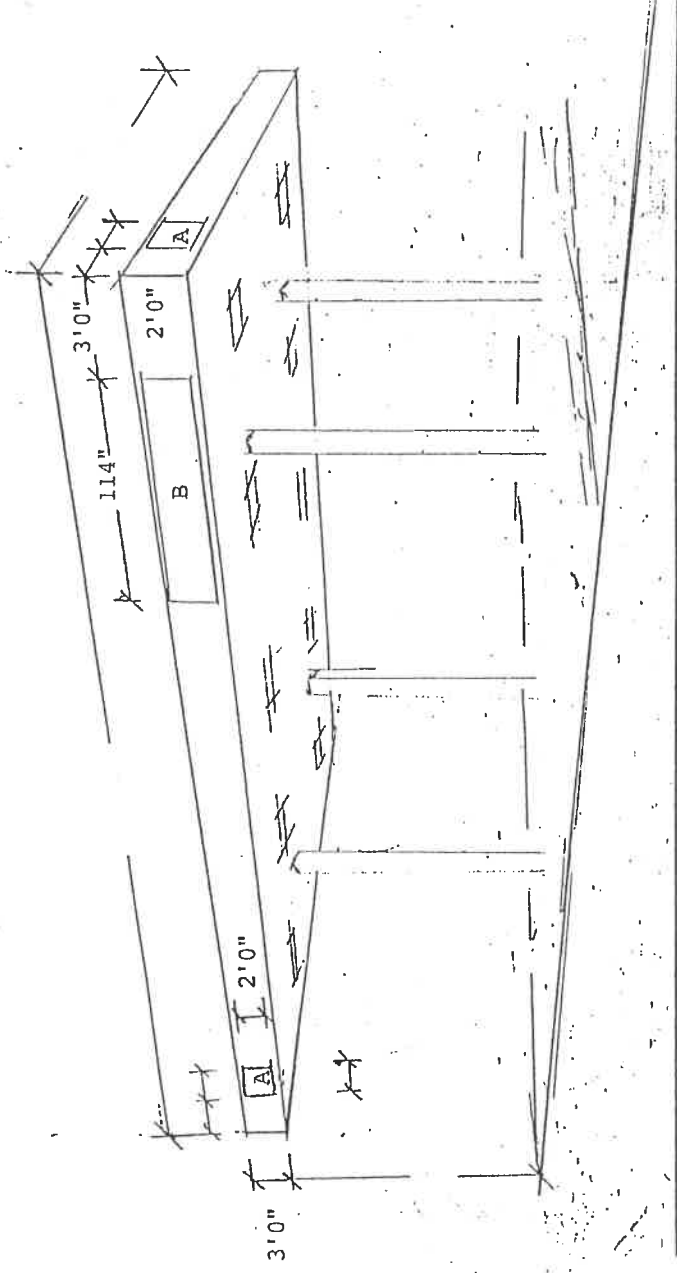

GRAPHIC "A"  
FLYING "S"

GRAPHIC "B"  
SPEEDWAY LETTERS



B

**\*National**  
ILLUMINATION & SIGN CORPORATION  
*The Lighting Maintenance Specialists*

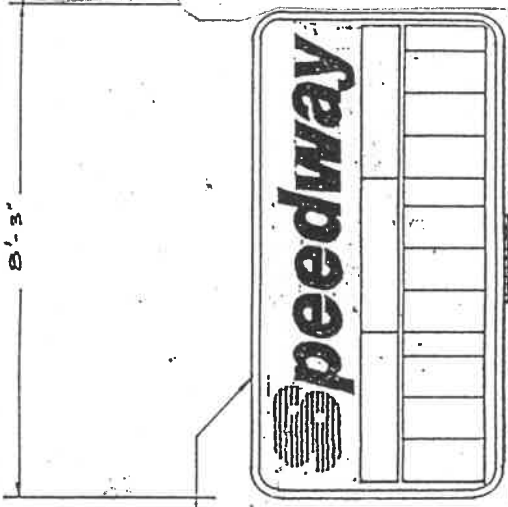

ILLUMINATED  
LOGO, I.D., PRICER  
4'-0" X 8'-1" X 12"  
SIGN CABINET  
33 ea.

4'-0"

12'-6"

GRADE



7-19-88 FROM BOTM-312ES OF SIGN

# SHROUD DESIGN COLUMN SIGN

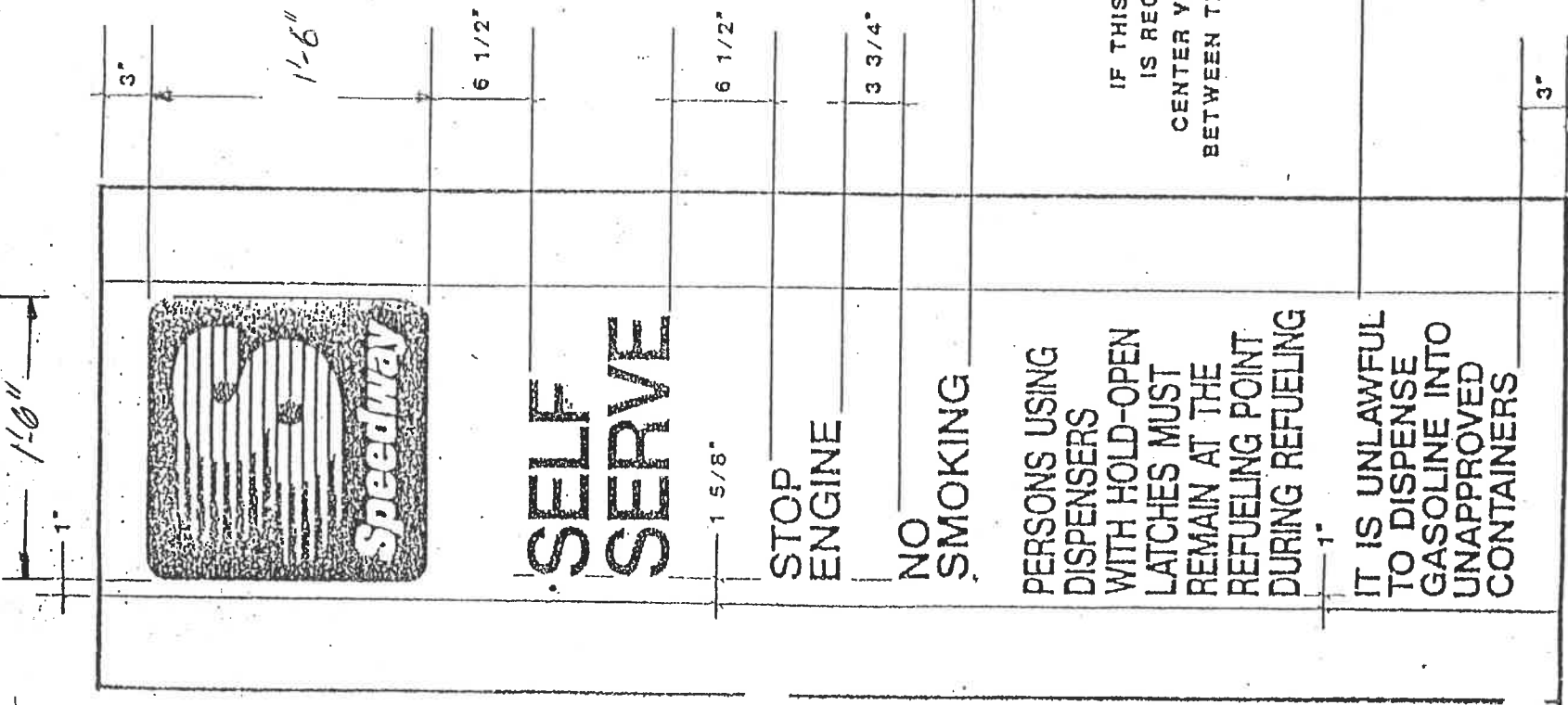

**SELF  
SERVE**

**STOP  
ENGINE**

**NO  
SMOKING**

**PERSONS USING  
DISPENSERS  
WITH HOLD-OPEN  
LATCHES MUST  
REMAIN AT THE  
REFUELING POINT  
DURING REFUELING**

**IT IS UNLAWFUL  
TO DISPENSE  
GASOLINE INTO  
UNAPPROVED  
CONTAINERS**

1'-6"  
2 LOGS

#D